

## Smart Riding Luggage User Manual

Please read this manual carefully before using the product and keep it properly

AOTOS

# Component Name

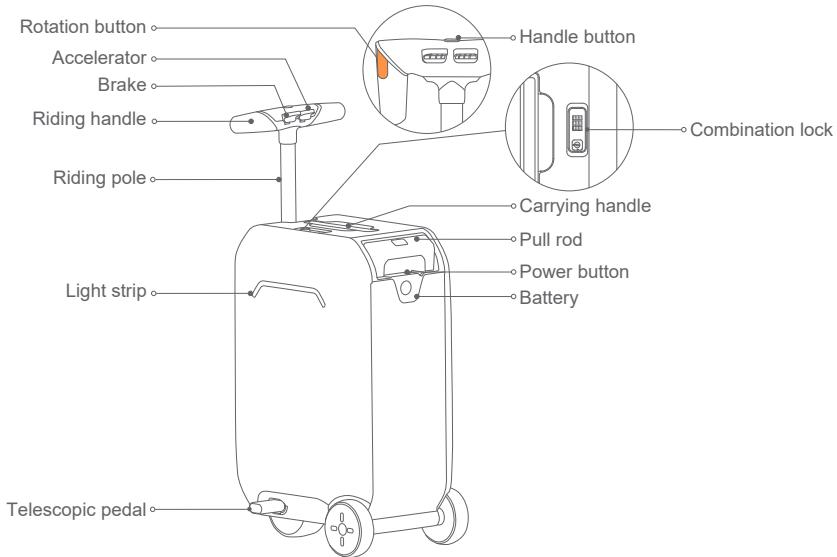

## Product Information

Size: 14.2x9.9x21.7Inch

N.W.: 19.18lbs

Volume: 31L

Tire Size: 4Inch

Rated Motor Power: 200W

Material: ABS+PC

Max Load: 242lbs

Max Range: 6.2miles

Max Speed: 6.2mph

Operating Temperature: -20 to 40°C

## Operation Instructions

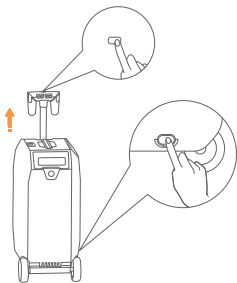

1. Press the handle button to pull up the riding pole of the luggage and press out the telescopic pedal.

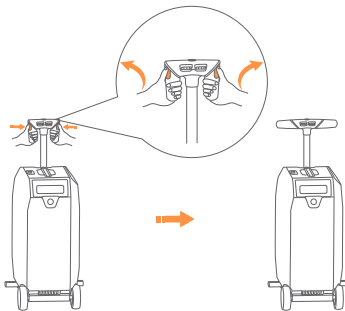

2. Hold the riding handle and press the rotation button, then rotate it 90° outward.

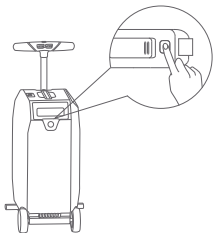

3. Press the power button of the battery to turn it on.

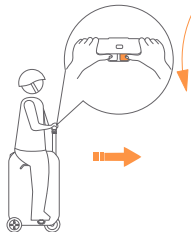

4. Hold the riding handle and press the accelerator to move the luggage forward.



5. Hold the riding handle and press the brake to slow down the luggage.

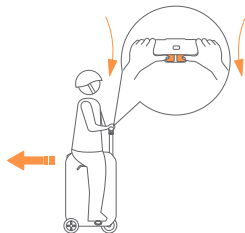

6. Hold the riding handle and press both the brake and accelerator to move the luggage backward.

## Riding Precautions

1. Before first use, it is recommended to fully charge the battery.
2. Avoid braking or turning sharply while riding to prevent skidding or overturning.
3. Follow traffic rules and venue regulations while using this product.
4. Avoid using this product in harsh weather conditions (such as rain, snow or icy environment).
5. Turn off the power when not in use.

## Using and Changing the Combination Lock

### Usage steps:

1. The default password of the luggage is: 000.
2. After entering the correct password, press the metal lock to open the lid.

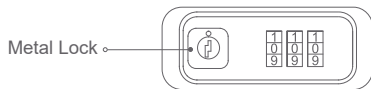

### Changing Password:

1. Open the lid and unzip the gauze on the top of the luggage to see the image on the right.
2. Pull the metal lever to B.
3. Set up a password.
4. Once set, push the metal lever back to A.

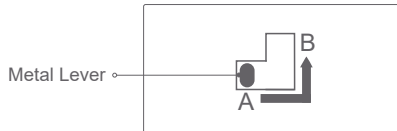

## Battery Parameters

Battery Capacity: 37VDC 2.5Ah

Battery Type: Li-ion Battery

Removable: Yes

Operating Temperature: -20 to 45°C

Charging Temperature: 0 to 40°C

Charging Time: 3-4h

Rated: 37VDC/92.5Wh

Charger Charging Voltage: 42VDC/1.0A

Input:42VDC/2A(Max)

Storage Temperature: -20 to 50°C

## Battery Installation and Removal

### Battery Installation:

1. Pull up the pull rod and insert the battery into the slot with the power display facing outward (as shown in the image on the right).

**\*Note: Do not install the battery backwards, or the product cannot be started.**

### Battery Removal:

1. Turn off the power and pull up the pull rod.
2. Hook the lanyard and pull out the battery (as shown in the picture on the right).

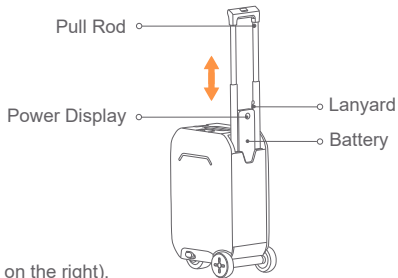

## Charging Precautions

1. When charging, please place it in a safe place where children cannot reach it.
2. If the charger is overheating, emits smoking or has an odor, stop using it immediately and seek professional help.
3. Use Only (FOSHAN SHUNDE GUANYUDA POWER SUPPLY CO LTD/Model: GC42-420100-1A) Charger
4. The charger contains high-voltage circuits, do not disassemble it without authorization.
5. Avoid liquid and metal chips from entering the charger and battery during use and storage.
6. Avoid covering the battery while charging.

## Precautions

1. Please strictly follow national or local laws and regulations when using this product.
2. Before using this product, read the instructions carefully for proper use and maintenance.
3. Before each use, carefully inspect the product's components to ensure they function properly, and take appropriate personal safety precautions.
4. Avoid riding on slippery, waterlogged, loose and other hazardous road conditions to avoid potential dangers to the product and personal safety.
5. Riding outdoors in rainy and snowy weather is prohibited.
6. This product is designed for single-person use only; carrying passengers is prohibited.
7. Pregnant women, minors under 14 years old and elderly people over 60 years old are prohibited from riding or learning to ride.

8. Riding is prohibited for individuals who are under the influence of drugs or alcohol and have impaired mobility or reaction time.
9. Do not place the battery near fire or in water.
10. Do not store the battery in flammable, explosive, corrosive and other hazardous environments.
11. Do not use non-original chargers for charging. We are not responsible for accidents caused by this.
12. Do not overload the product with less 79lbs and more than 242.5lbs or ride on slopes steeper than 10%.
13. Do not ride with objects hanging on the handlebars.
14. Riders are prohibited from riding when it is unsafe due to personal or other external situations.
15. Metal conductive objects (such as wires, keys, etc.) must no come in contact with the positive and negative terminals of the battery.
16. Unauthorized disassembly or modification is prohibited.
17. Do not place the scooter in a high temperature higher than 122°F or a low temperature lower than -4°F. Do not put the scooter into a fire, otherwise it may lead to battery failure, overheating, and even fire risk.
18. The battery is intended to be charged when the ambient temperature is between 0°C (32°F) and 40°C (104°F).  
Never charge the battery when ambient temperatures are outside this range.

## Use and Maintenance

1. Please use the original battery and charger. Using accessories from other models or brands may pose safety risks.
2. Charge the battery in time and avoid letting it fully discharge, as this will help extend the lifespan of the battery.
3. If the product is not used for more than 30 days, please fully charge it first, store it in a cool and dry place, and charge the battery to at least 75% every 30 days to avoid damage caused by over-discharge.
4. When used at room temperature, the battery delivers better battery life and performance; In low temperatures ( $<0^{\circ}\text{C}$ ), battery life and performance will drop significantly and will recover once the temperature rises ( $>20^{\circ}\text{C}$ ).
5. The battery should be handled with care during use to avoid collisions, falls and other situations that damage its internal stability.
6. Improper disposal of used batteries can cause serious environment pollution. Please follow local regulations when disposing of used battery packs. Do not discard the battery (battery pack) carelessly to protect the natural environment.
7. When cleaning, do not use damp cloth to wipe electrical components and connectors.

## Battery Maintenance

- Do not use battery packs of other models or brands, or there may be safety risks. It is strictly forbidden to disassemble, squeeze, or puncture this product. It is forbidden to throw this product into water, fire (including heat sources such as stove, heater, etc.) or expose it to an environment with a temperature higher than 50°C.
- Water entering the battery may cause damage to the internal circuit, and there is a risk of fire or even explosion. If the battery is suspected of water entering, please stop using it immediately and contact the aftersales service.
- Do not touch the battery contacts, disassemble or puncture the battery pack. Avoid metal objects contacting the battery contacts, or it may cause short circuits, damage to the battery, personal injury or death.
- Avoid recharging after the battery is completely depleted, and try to charge as soon as possible, to prolong the battery life.
- Only use the original battery charger when charging, or there may be a danger of damage or fire.
- Please fully charge the battery before storing it after each use, which will help to prolong the battery life.
- Do not place the equipment in an environment above 50°C or below -20°C (for example: in a car exposed to the sun in summer). It is forbidden to throw the scooter into a fire, or else it may the battery to failure, overheat, and even cause a fire.
- When used at normal temperature, the battery pack can exert a greater range and performance. If used in an environment below 0°C, the battery life and performance will be reduced. For details, please refer to the remaining mileage display in the app.
- If be used for a long time, please fully charge it first, store in a cool and dry place, and fully charge it every 30 days, or else the battery may be damaged and such damage is not covered by the warranty.

- Improper disposal of the used batteries can cause serious environment pollution. Please follow local regulations when disposing the used battery packs. Do not discard the battery pack carelessly to protect the natural environment.

**Physical protection:**

The battery should be kept in its original packaging or placed in an anti-static container. It is prohibited to stack it barehanded. The stacking height should not exceed 1.5 miles to avoid deformation due to compression and internal short circuits. Damaged, bulging or leaking batteries should be immediately isolated and stored in an explosion-proof cabinet.

**Partition and Isolation:**

Lithium-ion batteries and lithium-metal batteries should be stored separately and in different compartments. Mixing is strictly prohibited. The storage area should be far away from oxidants, flammable liquids, and corrosive substances, with a distance of  $\geq 2$  miles. When storing in large quantities, an independent fire compartment should be set up, and appropriate fire-fighting equipment should be provided.

**Packaging and Protection Measures:**

The batteries should be stored separately and kept away from metal items to prevent short circuits. A dedicated storage box or plastic bag specifically designed for batteries can be used for isolation and protection.

**Regular inspection and maintenance:**

Regularly inspect the appearance and performance indicators of the battery to ensure it is in a normal state. For batteries that have not been used for a long time, appropriate charging and discharging maintenance should be carried out to maintain their optimal condition.

## Mobile APP Connection Guide

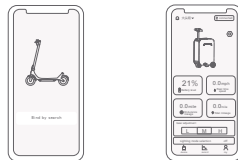

**1. Download:** Scan this QR code and download the APP.

**2. Connect:** Open the APP, complete the registration of a new account, turn on Bluetooth and tap "Search".

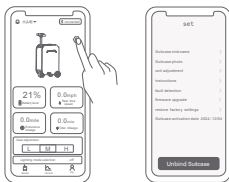

**3.Delete:** If someone else needs to connect to the product, Bluetooth must first be unpaired.

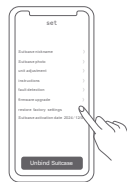

**4. Reset:** Tap "Reset" on the Settings interface.

\* Reset: The power level is reset to M and the lighting mode is reset to flow pattern.

## Product Certificate

Product Name: Smart Ridding Luggage

Product Model: L2

Manufacturer: SINO MEGWELL TECH INC



### Limited Warranty Statement

#### 30 DAY SATISFACTION GUARANTEED RETURN POLICY

If you are unsatisfied with your purchase, AOTOS return policy allows you to return the product purchased on the Authorization channel within 30 days counting from the date of receipt of shipment, and request a refund from the Authorization channel for any reason.

#### NOTE:

Express shipping cost is nonrefundable.

For the return request, AOTOS is not responsible for lost packages due to the carrier, or products received that cannot be verified. Received products that have damage determined to have been caused by the end-user may be subject to denial of the return request.

## HOW TO OBTAIN WARRANTY SERVICE

A Warranty Service Order must be requested from AOTOS within Warranty Period from the date of receipt of shipment. To request a Warranty Service Order, contact AOTOS: support@aotos.com after-sales service : +1 (626) 989-0826

To obtain warranty service, you must deliver the product, in either its original packaging or packaging providing an equal degree of protection, to the address specified by AOTOS. In accordance with applicable law, AOTOS may require the customer to furnish proof of purchase details and/or comply with registration requirements before receiving warranty service. Period or thirty (30) days, whichever is longer, or for any additional period of time that may be applicable in your jurisdiction.

### TO QUALIFY FOR A REFUND, ALL THE FOLLOWING CONDITIONS MUST BE MET:

1. A Return Merchandise Authorization (RMA) must be requested from AOTOS within 30 days from the date of receipt of shipment. To request an RMA, contact AOTOS Service: support@aotos.com after-sales service : +1 (626) 989-0826
2. The cost of return shipping will be borne by the customer.
3. For warranty service, please keep your receipt and/or invoice to validate proof of purchase.
4. Returned product must be in good physical condition (not physically broken or damaged).

5. All accessories originally included with your purchase must be included with your return.

6. If you return a product to AOTOS (a) without an RMA from AOTOS(b) without all parts included in the original package, AOTOS retains the right to refuse delivery of such return.

## Warranty Content

Type	Parts	Times
Main Parts	Hardware frame of the suitcase, motor bracket, riding pole	1 Year
Attachment	Motor, battery, charger, controller, accelerator, brake, ringing handle, pull rod	6 Month
Wearing Parts	Light strip, rear wheels, plastic of the suitcase, exterior decorative parts, other plastic parts, linings	3 Month

Persons with any mental or physical conditions that may make them susceptible to injury or impair their physical dexterity or mental capabilities to recognize, understand, and perform all of the safety instructions and to be able to assume the hazards inherent in unit use.

WARNING – Risk of Fire and Electric Shock – battery and/or battery components are not user replaceable

AVERTISSEMENT – Risque d'incendie et de décharge électrique – Les batteries ou leurs composants ne peuvent pas être remplacés par l'utilisateur.

WARNING - Risk of Fire and No User Serviceable Parts.

AVERTISSEMENT- Risque d'incendie - Aucune des pièces ne peut être réparée par l'utilisateur.

Prolonged Exposure to UV Rays, Rain and the Elements May Damage the Enclosure Materials,

Store in doors When Not in Use.

Risque d'incendie et de choc électrique-pas de pièces utilisables l'exposition prolongée aux rayons uv, à la pluie et aux éléments peut endommager les matériaux de l'enceinte, entreposer à l'intérieur quand il n'est pas utilise.

Not intended for use at elevations greater than 2000 m above sea level.



This device complies with Part 15 of the FCC Rules. Operation is subject to the following two conditions:

(1) This device may not cause harmful interference.

(2) This device must accept any interference received, including interference that may cause undesired operation.

2. Changes or modifications not expressly approved by the party responsible for compliance could void the user's authority to operate the equipment. Note: This equipment has been tested and found to comply with the limits for a class B digital device, pursuant to Part 15 of the FCC Rules.

These limits are designed to provide reasonable protection against harmful interference in a residential installation.

This equipment generates uses and can radiate radio frequency energy and, if not installed and used in accordance with the instructions, may cause harmful interference to radio communications.

However, there is no guarantee that interference will not occur in a particular installation.

If this equipment does cause harmful interference to radio or television reception, which can be determined by turning the equipment off and on, the user is encouraged to try to correct the interference by one or more of the following measures:

- Reorient or relocate the receiving antenna.
- Increase the separation between the equipment and receiver.
- Connect the equipment into an outlet on a circuit different from that to which the receiver is connected.
- Consult the dealer or an experienced radio/TV technician for help. The device has been evaluated to meet general RF exposure requirement. The device can be used in portable exposure condition without restriction.



English: This device complies with Industry Canada license-exempt RSS standard(s). Operation is subject to the following two conditions:

(1) This device may not cause interference ;

(2) This device must accept any interference received, including interference that may cause undesired operation of the device. The digital apparatus complies with Canadian CAN ICES (B)/NMB (B)

(B). - French: Le présent appareil est conforme aux CNR d'Industrie Canada applicables aux appareils radio exempts de licence. L'exploitation est autorisée aux deux conditions suivantes:

(1) l'appareil ne doit pas produire de brouillage, et (2) l'utilisateur de l'appareil doit accepter tout brouillage radioélectrique subi, même si le brouillage est susceptible d'en compromettre le fonctionnement. L'appareil numérique est conforme à la canadienne CAN ICES (B)/NMB (B). Radiation Exposure Statement The device has been evaluated to meet general RF exposure requirement. The device can be used installed and operated with minimum distance 0mm between the radiator and your body. L'appareil a été évalué pour répondre aux exigences générales d'exposition aux RF. Cet équipement doit être installé et utilisé avec une distance minimale de 0 mm entre le radiateur et votre corps.





AOTOS

物料名称: L2行李箱说明书(美规)

料号: B.01.003.0752

材质: 80g太空梭亚光双铜, 正反印刷双面过哑油

印刷颜色: 2C印刷 PANTONE 715 C/PANTONE Cool Gray 11 C

成型方式: 打钉

尺寸: 148x98mm

封面/封底内页空白